

# ICUTRONIC® LED Power Supply

IT FIT 20/220-240/500 CS I  
 IT FIT 30/220-240/700 CS I  
 IT FIT 40/220-240/1A0 CS I

PN1	PN2	PN3	Inrush [mA]	Power [W]	Rated [V <sub>AC</sub> ]	U <sub>in</sub> [V]	f <sub>in</sub> [Hz]	I <sub>n</sub> [A]	t <sub>a</sub> [°C]	A	t <sub>c</sub> = 70°C
OFF	OFF	OFF	150	6.3				0.054	0.75C-0.93C		
ON	OFF	OFF	200	8.4				0.092	0.8C-0.93C		
OFF	ON	OFF	250	10.5				0.071	0.85C-0.96C		
ON	ON	OFF	300	12.6				0.088	0.91...0.95		
OFF	OFF	ON	350	14.7	23-42	220-240V	50/60Hz	0.088	0.9C-0.98		
ON	OFF	ON	400	16.8				0.107			
ON	ON	ON	450	18.9				0.117			
ON	ON	ON	500	21.0							

IS 16885  
 Part 2/SEC 13)  
 R-41244147  
 www.bis.gov.in

**SELV**

SEC ==  
 I-OUT-REGV  
 LED-Only

TEB 1653351

LED-●22  
 LED-●21

wire preparation:  
 push in  
 s: 0.75 - 1.5  
 f: 0.75 - 1.5

Inventronics GmbH  
 Belfiore Allee 65  
 86153 Augsburg  
 Germany  
 www.inventronicsglobal.com

Made in China

picture only for reference, valid print on product<sup>4)</sup>

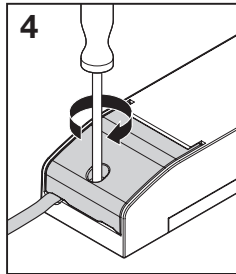
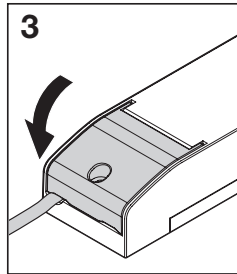
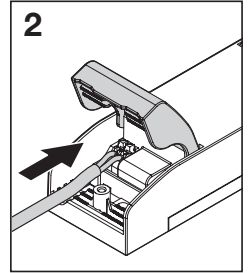
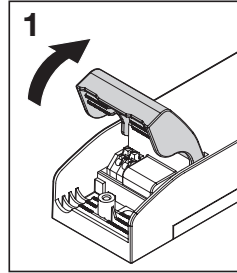

Cable types (tested acc. to EN 60598-1)<sup>11)</sup>

INPUT:  
 Left: H03VH2-F 2x0.75mm<sup>2</sup> /  
 H03V-F 2x0.75mm<sup>2</sup> /  
 H05V-F 2x1.0mm<sup>2</sup> /  
 Right: H05V-F 2x1.0mm<sup>2</sup> /  
 H05V-F 2x1.5mm<sup>2</sup>

OUTPUT:  
 Left: 20AWG X 2 /  
 H03VH2-F 2x0.75mm<sup>2</sup> /  
 H03V-F 2x0.75mm<sup>2</sup> /  
 Right: H03VH2-F 2x0.75mm<sup>2</sup> /  
 H03V-F 2x0.75mm<sup>2</sup> /  
 H05V-F 2x1.0mm<sup>2</sup>

Year<sup>9)</sup> Week<sup>10)</sup>

02627

026 27

**A**

Input<sup>6)</sup> Output<sup>7)</sup>

Mains<sup>5)</sup>

2 ~  
 1 ~  
 ~220...240V

**IT FIT**

SEC

+

22

-

21

**SELV**

8) wire preparation  
 push in  
 s: 0.75 - 1.5  
 f: 0.75 - 1.5  
 7 - 8 mm

IT FIT	20W	30W	40W
Inrush (A)	18	23	32
T half pulse width(μs)	134	50	100
B16	58	57	42
B10	36	36	26
C16	97	96	70
C10	61	60	44

Ⓢ Installing and operating information (SELV driver): Connect only LED load type. Shutdown of load happens if U<sub>LED</sub> is outside the U<sub>rated</sub> range given for each driver. The LED driver relies upon the luminaire enclosure for protection against accidental contact with live parts when without cable clamp caps. Wiring information (see fig. A): Do not connect the outputs of two or more units. Unit is permanently damaged if mains is applied to the terminals 21-22. Lines 21/22 max. 2 m whole length excl. modules. Please make sure to switch off the driver via L. Hot plug-in or secondary switching of LEDs is not permitted. Technical support: www.inventronicsglobal.com

1) Constant current LED Power Supply; 2) t<sub>c</sub> point; 3) Made in China; 4) picture only for reference, valid print on product; 5) Mains; 6) Input; 7) Output; 8) wire preparation; push in; 9) Year; 10) Week; 11) Cable types (tested acc. to EN 60598-1)

ⓓ Installations- und Betriebshinweise (SELV-Treiber): Schließen Sie nur LED-Lasttypen an. Die Lastabschaltung erfolgt, wenn sich U<sub>LED</sub> außerhalb des für jeden Treiber vorgegebenen Nennspannungsbereichs befindet. Der LED-Treiber ist zum Schutz gegen zufälliges Berühren aktiver Teile auf das Leuchtengehäuse angewiesen, wenn er ohne Kabelklemmkappen verwendet wird. Verdrahtungshinweise (siehe Abb. A): Die Ausgänge von zwei oder mehreren Geräten dürfen nicht verbunden werden. Das Gerät wird dauerhaft beschädigt, wenn an die Klemmen 21 bis 22 Netzversorgung angelegt wird. Maximale Gesamtlänge der Leitungen 21/22: 2 m ohne Module. Bitte achten Sie darauf, den Treiber über L auszuschalten. Der Anschluss von LEDs im laufenden Betrieb oder sekundäres

Schalten ist nicht zulässig.

Technische Unterstützung: [www.inventronicsglobal.com](http://www.inventronicsglobal.com)

- 1) Konstantstrom-LED-Betriebsgerät; 2)  $t_c$ -Punkt; 3) Hergestell in China; 4) Foto dient nur als Referenz, gültiger Aufdruck auf dem Produkt; 5) Netzversorgung; 6) Eingang; 7) Ausgang; 8) Drahtvorbereitung; einstecken; 9) Jahr; 10) Woche; 11) Kabelarten (getestet nach EN 60598-1)

Ⓔ Informations pour l'installation et le fonctionnement (Alimentation SELV) : Connecter uniquement un type de charge LED. La coupure de charge survient lorsque l'U<sub>LED</sub> ne respecte pas la plage nominale spécifique pour chaque pilote. Le pilote LED est protégé par le boîtier du luminaire de tout contact accidentel avec les pièces sous tension en l'absence de fixations de câble. Informations de câblage (voir fig. A) : ne pas brancher les fils de sortie de deux unités ou plus. Le raccordement secteur aux terminaux 21-22 causera des dommages irréversibles à l'unité. Longueur maximale des lignes 21/22 : 2 m sans modules. Veillez à éteindre le pilote via L. Le branchement à chaud et la commutation secondaire des LED ne sont pas autorisés. Support technique : [www.inventronicsglobal.com](http://www.inventronicsglobal.com)

- 1) Alimentation LED courant constant; 2) Point  $T_c$ ; 3) Fabrique en Chine; 4) image non contractuelle, se référer aux inscriptions sur le produit; 5) Alimentation électrique; 6) Entrée; 7) Sortie; 8) préparation du câble; pression; 9) Année; 10) Semaine; 11) Types de câbles (testé conformément à la norme EN 60598-1)

Ⓕ Informazioni su installazione e funzionamento (Driver SELV): Collegare solo il tipo di carico LED. Lo spegnimento del carico si verifica se U<sub>LED</sub> non rientra nel limite della tensione nominale indicato per ciascun driver. L'involucro dell'apparecchio d'illuminazione protegge il driver LED dal contatto accidentale con parti soggette a tensione se sprovvisto di coperchi per morsetto del cavo. Informazioni sul cablaggio (vedi figg. A): Non collegare insieme le uscite di due o più unità. L'unità è danneggiata permanentemente se la tensione di rete viene applicata ai terminali 21-22. Linee 21/22 max. 2 m lunghezza intera esclusi moduli. Si prega di disattivare il driver via L. Non sono permessi l'hot swap o il switching secondario dei LED. Supporto tecnico: [www.inventronicsglobal.com](http://www.inventronicsglobal.com)

- 1) Alimentazione LED a corrente costante; 2) Punto  $t_c$ ; 3) Prodotto in Cina; 4) immagine solo come riferimento, stampa valida sul prodotto; 5) Rete; 6) Ingresso; 7) Uscita; 8) cablare; inserire i cavi; 9) Anno; 10) Settimana; 11) Tipi di cavi (testati ai sensi di EN 60598-1)

Ⓖ Installatie- en gebruiksinstructies (SELV-driver): Sluit alleen het type voor LED-vermogen aan. De belasting wordt uitgegeschakeld als U<sub>LED</sub> buiten het Unominale bereik valt met voor elke driver is opgegeven. Als de kabelklemmen niet zijn afgedekt, is de led-driver afhankelijk van de armatuur voor bescherming tegen onbedoeld contact met onder spanning staande onderdelen. Informatie over bedrading (zie fig. A): Sluit de uitgangsdraad van twee of meer eenheden

Ⓔ IT FIT 20 CS I, IT FIT 30 CS I classified as "Do not Cover" (see symbol on the right): The independent LED driver can be used where normally flammable materials, including building insulation, are or may be present, but cannot be abutted against any material and cannot be covered in normal use.

IT FIT 40 CS I classified as "Non IC": The independent LED driver cannot be abutted against or covered by normally flammable materials or used in installations where building insulation or debris is, or may be, present in normal use. No use for residential installations. The minimum clearance distance from the top and sides of the independent LED driver to normally flammable building elements is A=B=C= 10mm.

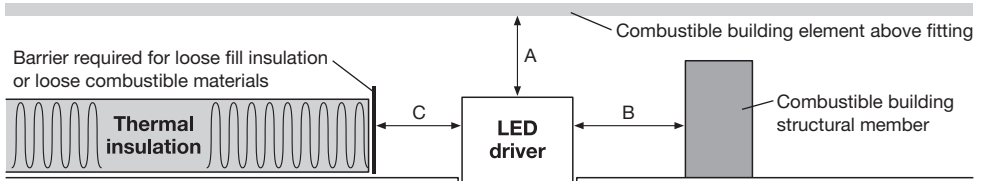
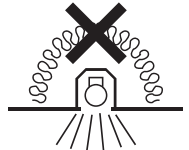

Ⓔ Inventronics Turkey Teknoloji Ticaret Limited Şirketi, Buyukdere Cad. Bahar Sok. River Plaza No: 13/5 Sisli 34394 Istanbul, Turkey

Ⓔ Inventronics Poland Sp. z o.o., Al. Jerozolimskie 94, 00-807 Warsaw, Poland

Ⓔ Forgalmazo: Inventronics Netherlands B.V., Polluxstraat 21, 5047RA Tilburg

Ⓔ Inventronics Netherlands B.V., Polluxstraat 21, 5047RA Tilburg

Ⓔ Uvoznik: Inventronics Netherlands B.V., Polluxstraat 21, 5047RA Tilburg

Ⓔ Инвентроникс Нидерландия Б.В., Полукстраат 21, 5047 РА Тилбург

Ⓔ Εισαγωγή: Inventronics Netherlands B.V., Polluxstraat 21, 5047RA Tilburg

Ⓔ Inventronics Guangzhou Technology Limited; Room 1105, Clifford Corporate Center Building, No. 15, Fuhua Road, Clifford Estate Panyu, Guangzhou, Guangdong province, China, Postal code: 511496

广州英飞特科技有限公司; 广州市番禺區村钟街祈福新邨福華路15号祈福集团中心1105室 邮编: 511496

Ⓔ INVENTRONICS MALAYSIA SDN. BHD., Kuala Lumpur, Penang, Tower A Vertical Business Suite

Ⓔ Inventronics Korea Inc, Seoul, Yeongdong-daero 417

인벤티트로닉스코리아 유한회사, 서울특별시 강남구 테헤란로25길 6-9, 6층 674호

Ⓔ INVENTRONICS (HONG KONG) LIMITED, Room 30-108C, 29/F, Tower 5, The Gateway, 15 Canton Road, Tsim Sha Tsui, Hong Kong

Ⓔ INVENTRONICS SSL India Private Limited, 4th and 5th floor, B Wing, Sky-Height, Valiper Road, Kalyan West Kalyan City, Thane, Kalyan, Maharashtra-421301

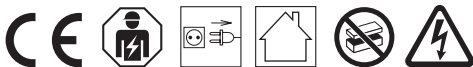

C10514269  
G15132244  
2026-02-03



[www.inventronicsglobal.com](http://www.inventronicsglobal.com)

Inventronics GmbH  
Berliner Allee 65  
86153 Augsburg  
Germany