

## DALI MCU TW G2

DALI MCU TW G2 | Light management systems



---

### Product family features

- Up to 4 DALI PCU TW G2 can be connected in parallel to set up multiple control points
- Automatic synchronization between the control points
- Cover and rotary switch in neutral white
- Length of the DALI control cable: up to 300 m

---

### Product family benefits

- Intuitive manual dimming, switching and changing of colour temperature
- Individual setting of minimal brightness level
- Individual setting of colour temperature range

## Areas of application

- Conference rooms
- Restaurants
- Shop lighting
- Private homes

## Technical data

### Electrical data

<b>Nominal voltage</b>	230 V
<b>Mains frequency</b>	50...60 Hz
<b>System wattage</b>	2 W

## Dimensions & weight

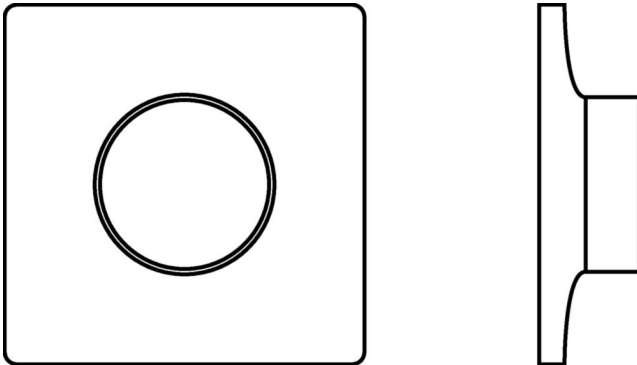

Product weight	95.00 g
Length	71.0 mm
Width	71.0 mm
Height	50.0 mm

## Colors & materials

Product color	White
---------------	-------

## Temperatures & operating conditions

Ambient temperature range	-20...+50 °C
---------------------------	--------------

## Capabilities

<b>Number of control outputs</b>	1
<b>Dimming interface</b>	DALI-2
<b>Dimmable</b>	Yes
<b>Type of installation</b>	Integrated in flush device box
<b>App Control</b>	No
<b>Max. number of connected controllers</b>	4

## Certificates & standards

Approval marks – approval	CE / UKCA / EAC
Protection class	2
Type of protection	IP20

## Logistical data

Commodity code	85365080900
----------------	-------------

## Environmental information

Information according Art. 33 of EU Regulation (EC) 1907/2006 (REACH)	
Primary Article Identifier	4062172224673   6977078993777
Date of Declaration	31-03-2026
Declaration No. in SCIP database	In work
SCIP_STATUS	In work
SCIP_ID	

## Equipment / Accessories

- Suitable for up to 25 electronic control gears
- Cover and rotary knob included

## Download Data

File		
CAD data 2-dim	Compressed	▶ DALI MCU TW G2 9C1-4553129-EN-00 2D(RL) 20112025
CAD data 3-dim	Compressed	▶ DALI MCU TW G2 9C1-4553129-000-00 3D 20112025
CAD data	Compressed	▶ DALI MCU TW G2 9C1-4553129-000-00 STP 20112025
CAD data	Compressed	▶ DALI MCU TW G2 9C1-4553129-000-00 IGS 20112025
User instruction	PDF	▶ DALI MCU TW G2 15130461 300625

## Logistical Data

Product code	Product description	Packaging unit (Pieces/Unit)	Dimensions (length x width x height)	Volume	Gross weight
6977078993777 INVENTRONICS	DALI MCU TW G2	Shipping carton box 48 Pieces	362 x 270 x 288 mm	28.15 dm <sup>3</sup>	149.08 g

The mentioned product code describes the smallest quantity unit which can be ordered. One shipping unit can contain one or more single products. When placing an order, for the quantity please enter single or multiples of a shipping unit

## Disclaimer

Subject to change without notice. Errors and omission excepted. Always make sure to use the most recent release.