

B NLC D HB LI

Light management systems



Product family features

- With/without Daylight and Occupancy Sensor D4i Module
- Bluetooth NLC enabled by Silvair
- Control of D4i drivers or DALI drivers with additional DALI bus power supply
- Intended for installation into a standard 1/2" knockout
- Works with Inventronics Hubsense®
- Works with Inventronics D4i LED drivers

Product family benefits

- Standard communication protocol released by Bluetooth SIG
- Design freedom due to compact size
- Easy to integrate in luminaire
- Minimize internal wiring in combination with D4i drivers
- Secured product communication granted by ioXT and PSA Certificates

Areas of application

- Open offices
- Individual offices
- Conference rooms
- Classrooms
- Storage and break areas
- Stairways
- Toilets
- Suitable for high installation heights
- Entrance halls
- High-bay warehouse
- Production halls

Technical data

Electrical data

Input voltage DC	12...22.5 V
Maximum TX power	+8 dBm
Peak input current	30 mA
Average input current	10 mA
Radio frequency	2.4 GHz
Wireless protocol	Bluetooth NLC enabled by Silvair
Wireless range	20 m line of sight
Standby power	< 150 mW
Required DALI current (typical)	10 mA
Peak DALI current	30 mA
System wattage	0.30 W

Dimensions & weight

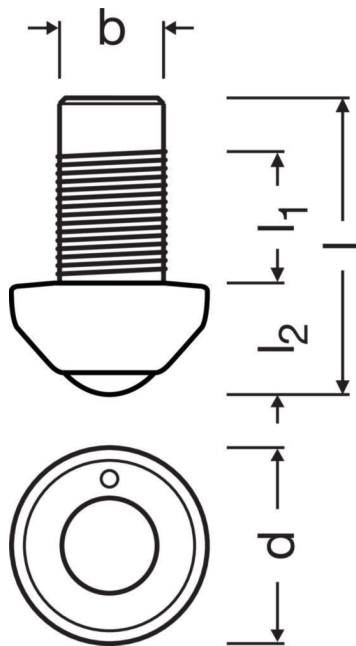

Product weight	18.20 g
Wire preparation length, input side	7...9 mm
Cable cross-section, input side	0.25...0.75 mm ²
Length	43.5 mm
Width	37.0 mm
Height	57.3 mm
Mounting hole diameter	22.2...23.2 mm
Maximum allowed cable length	10
Screw thread length	25 mm
Diameter	37.0 mm

Temperatures & operating conditions

Maximum temperature at tc test point	60 °C
Ambient temperature range	-20...+50 °C
Temperature range at storage	0...70 °C
Permitted rel. humidity during operation	0...90 %
Permitted relative humidity at storage	0...95 %

Lifespan

Lifespan	50000 h
-----------------	---------

Capabilities

Operating range, light sensor	<1000 lx
Detection angle	360 °
Dimming interface	D4i
Detection area	12 m ²
Type of sensor	Daylight / PIR
Dimmable	Yes
Type of installation	Luminaire integration
Compatibility	Works with Inventronics HubSense / Works with Inventronics DEXAL
Control output	D4i
Status Indicator	Blue: network Status / Red: Motion detected
Reset	Magnetic ¹⁾
Number of connected drivers	4
Control interface	Bluetooth NLC
Detection angle (Light sensor)	+/- 15°
Detection angle (PIR)	+/-60°

1) by magnet

Certificates & standards

Approval marks – approval	CE / ioXT / PSA
Protection class	II
Type of protection	IP65

Environmental information

Information according Art. 33 of EU Regulation (EC) 1907/2006 (REACH)	
Primary Article Identifier	6977078990363
Date of Declaration	06-05-2026
Declaration No. in SCIP database	In work
SCIP_STATUS	In work
SCIP_ID	

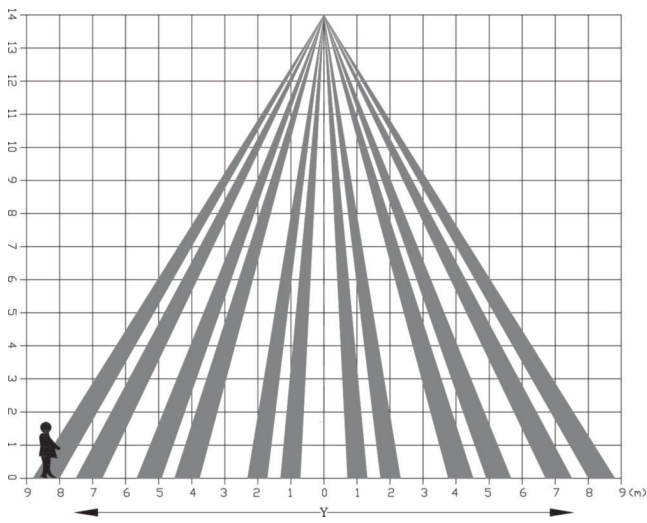

LS PD HB R Detection Pattern 2

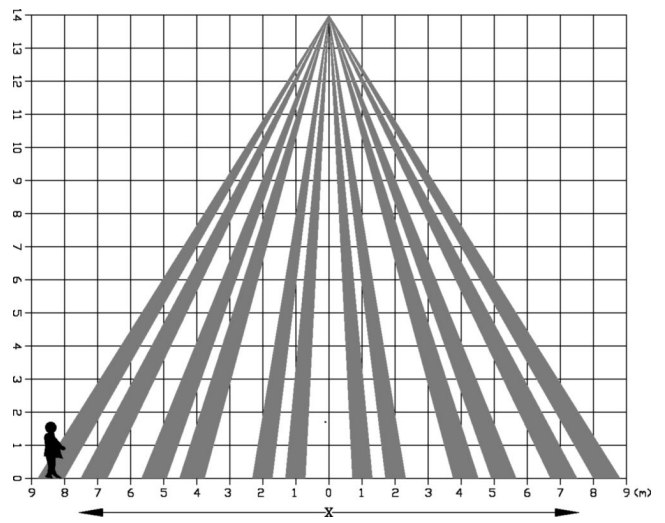

LS PD HB R Detection Pattern 1

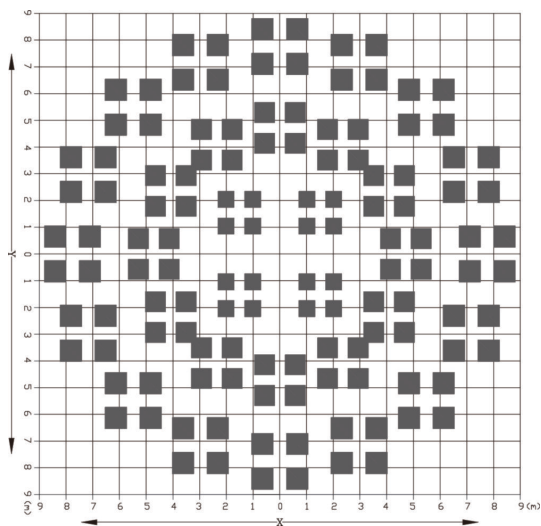

LS PD HB R Detection_Pattern

Download Data

File		
Certificates	PDF	▶ B NLC D QBM D4i CE 4322567 06 030925
CAD data 2-dim	Compressed	▶ B NLC D HB LI 2PDF 4552238 031125
CAD data 3-dim	Compressed	▶ B NLC D HB LI 3PDF 4552238 031125
CAD data	Compressed	▶ B NLC D HB STEP 200824
CAD data	Compressed	▶ B NLC D HB LI STEP 4552238 031125
CAD data	Compressed	▶ B NLC D HB LI IGS 4552238 031125
User instruction	PDF	▶ G15129683_B-NLC-D-OF-LI__B-NLC-D-LI-R__B-NLC-D-OF-LI-S_07.pdf
User instruction	PDF	▶ G15130022_B_NLC_D_HB_MB_LB_LOW_03

Logistical Data

Product code	Product description	Packaging unit (Pieces/Unit)	Dimensions (length x width x height)	Volume	Gross weight
6977078990363 INVENTRONICS	B NLC D HB LI	Shipping carton box 50 Pieces	330 x 287 x 195 mm	18.47 dm ³	30.60 g

The mentioned product code describes the smallest quantity unit which can be ordered. One shipping unit can contain one or more single products. When placing an order, for the quantity please enter single or multiples of a shipping unit